

Plates for spray bottle installation for hi-hat stand FPS-01

Thank you very much for purchasing our product.

How to use, and attach

1. Remove the clutch, pull out the shaft, and pass the base plate from below. (The felt side is on top.)

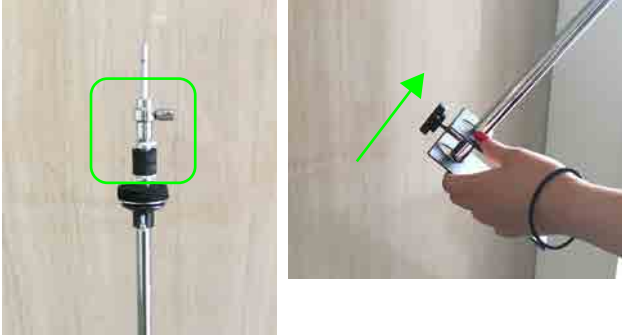

3. Insert the push plate into the clutch, return it to the shaft, and fix it according to the height of the bottle. (The felt side is on the bottom.)

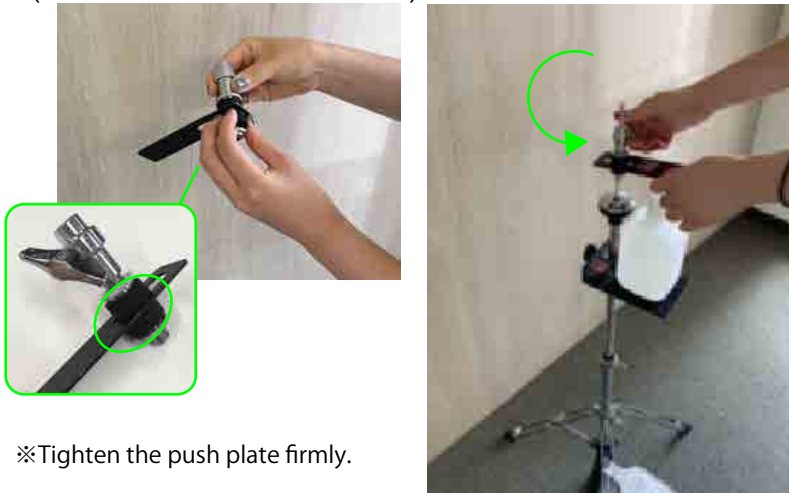

※Tighten the push plate firmly.

■ Safety precautions

Never fail to observe. Items described here are for using the product safely and properly, and to prevent hazards and injury to the user and other persons before they occur. After reading this manual, the user should preserve it in a place where it can be referred to at any time.

Notes on installation

- WARNING** **Use according to the standard which is based in the specifications.** It may cause damage, accident, or malfunction if it is installed out of standard.
- WARNING** **Install the product in the place where is sturdy and flat properly.** If you install the product improperly or if you step on the pedal the place where there is a bump, it may cause a fall, injury, malfunction.

Precautions for use

- CAUTION** **Perform regular inspections.** Perform regular inspections and do the cleaning to maintain the safety and performance of installation.

Precautions for relocation/repair

- WARNING** **Never disassemble, repair or modify.** Never modify the shaver. Only a qualified technician may make repairs. (Cause of fires, electric shocks or injury) - Consult your distributor for repair.

Precautions for disposal

- CAUTION** **Follow local rules when disposing of the product.**

Items

- Push Plate × 1
- Base Plate × 1
- Knob Bolt × 1

※The knob bolt is attached to the base plate.

The stand and bottle are not included in the product.

2. Return the shaft, adjust the height of the base plate and tighten the knob. ※If it is not fixed, it may fall. Tighten the knob properly.



4. By stepping on the pedal, the push plate moves up and down, spraying.



WARNING/CAUTION

Items are classified as follows. All items are important descriptions related to safety, therefore make sure to observe them.

- WARNING** Extent of hazard which has the potential to cause death or serious injury to the user in the case of improper handling.
- CAUTION** Extent of hazard or damage which has the potential to cause injury to the user or damage to physical property (houses and household goods) in the case of improper handling.

※Example of graphic illustration

- This symbol means "prohibited" (never do this).
- This symbol means "compulsory" (be sure to do).

Manufacturer

HarmoTECH Co., LTD.

125 Daikumachi, Naka-ku, Hamamatsu,
Shizuoka, Japan 430-0936



- Contact us -

Mail. info@harmotech.co.jp
URL. www.harmotech.co.jp



※The product design, specifications, appearance, and prices may change without prior notice. We appreciate your understanding.